



CZ-H37S

Reflective Sensor Head with Shine Cancellation, Small Spot



*Please note that accessories depicted in the image are for illustrative purposes only and may not be included with the product.

Specifications

Model		CZ-H37S
Type		Lustre-cancel, small beam spot
Detecting area		11 to 20 mm (Reco mmended: 15 mm)
Smallest spot diameter		1 mm dia. at reference distance of 16 mm
Light source		Red LED (665 nm)/Green LED (520 nm)/Blue LED (465 nm)
Minimum bend radius of fi bre		15 mm
Environmental resistance	Enclosure rating	IP40
	Ambient light	Incandescent lamp: 10,000 lux max., Sunlight: 20,000 lux max.
	Ambient temperature	-10 to +55 °C (No freezing)
	Vibration resistance	10 to 55 Hz, Double amplitude 1.5 mm, 2 hours in each of the X, Y, and Z axis
Material		Housing : Triacetate, Polyarylate (Metal section: TYPE 304 stainless steel) , Lens cover : Fibreglass reinforced plastic
Weight		Approx. 45 g

Dimensions

* Download CAD file or product manual for larger image/text and more detail.

CZ-H37S

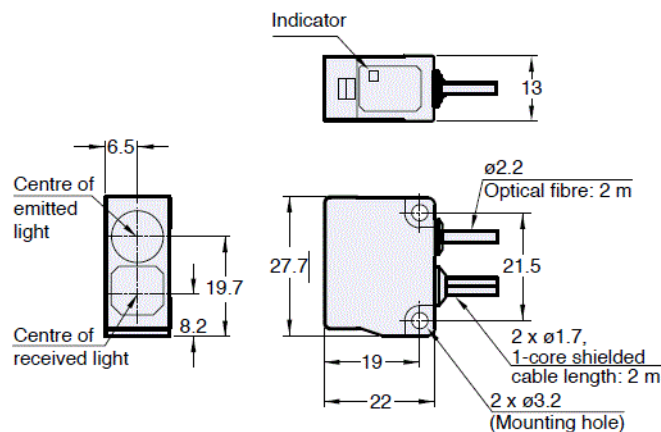

When a mounting bracket is attached

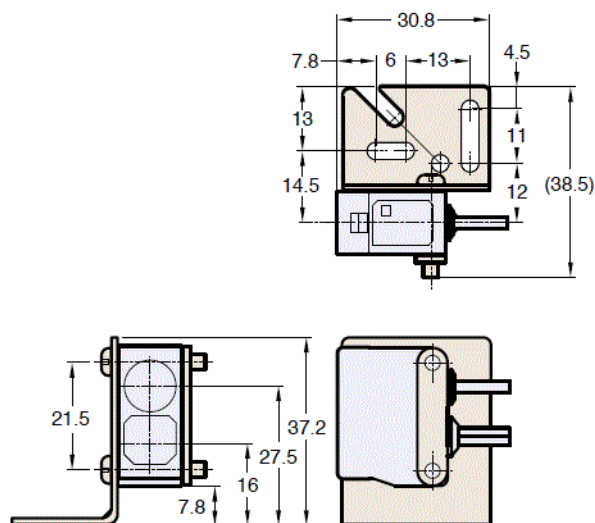

Mounting bracket
(Supplied with the CZ-H32, H35S, and H37S)

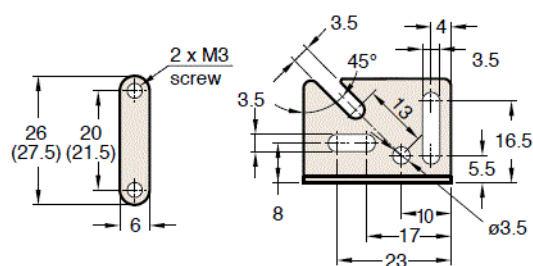

Material: TYPE 304 stainless steel
t=1.5

The figures in parentheses apply to CZ-H37S only.

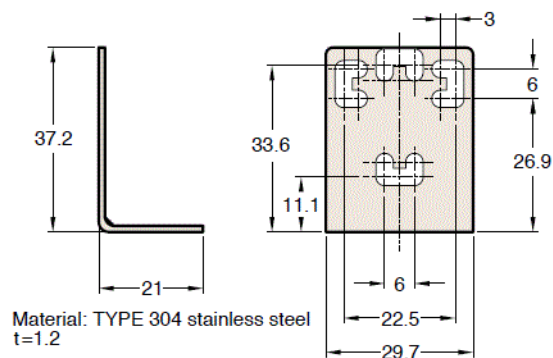

Material: TYPE 304 stainless steel
t=1.2

Supplied screw: 20 x M3 screws (2)