



SR-700

Ultra-compact, Fixed type Code Reader



*Please note that accessories depicted in the image are for illustrative purposes only and may not be included with the product.

Specifications

Model			SR-700
Type			Close-range type
Laser pointer	Light source		Visible semiconductor laser (Wavelength : 660 nm)
	Output		60 μW
	Pulse duration		200 μs
	Laser class		Class 1 Laser Product (IEC60825-1, FDA (CDRH) Part 1040.10*1)
Lighting	Light source		High intensity red LED
Reading	Supported code	Barcode	CODE39, ITF, 2of5 (Industrial 2of5), COOP 2of5, NW-7 (Codabar), CODE128, GS1-128, GS1 DataBar, CODE93, JAN/EAN/UPC, Trioptic CODE39, CODE39 Full ASCII, Pharmacode
		2D code	QR, MicroQR, DataMatrix (ECC200), GS1 DataMatrix, PDF417, Micro PDF417, GS1 Composite (CC-A, CC-B, CC-C)
	Minimum resolution	Barcode	0.127 mm
		2D code	
	Reading distance (typical examples)	Barcode	30 to 100 mm (Narrow bar width = 0.33 mm)
		2D code	40 to 80 mm (Cell size = 0.25 mm)
	Focal distance		60 mm
	Field of view (Typical example at focal distance)		42 mm × 27 mm
I/O	Control input		2 inputs (IN1 and IN2), non-voltage input (contact, solid-state)
	Control output		4 NPN open collector outputs (OUT1 to 4) 30 mA or less (24 V or less) Residual voltage 0.8 V or less, leakage current 0.1 mA or less
	RS-232C	Transmission speed	9600, 19200, 38400, 57600, 115200 bps
		Supported protocol	No-protocol, MC protocol, SYSWAY, KV STUDIO
	USB		USB 2.0 Full Speed compliant
Rating	Power voltage		5 VDC +5 %, -10 %
	Current consumption		630 mA or less
Environmental resistance	Enclosure rating		IP65
	Ambient light		Sunlight: 10,000 lux, Incandescent lamp: 6,000 lux, Fluorescent lamp: 2,000 lux
	Ambient temperature		0 to +45 °C
	Relative humidity		35 to 95 % RH (No condensation)
	Storage temperature		-10 to +50 °C (No freezing)
	Operating environment		No dust or corrosive gas present
	Vibration resistance		10 to 55 Hz, Double amplitude 1.5 mm, 3 hours in each of the X, Y, and Z directions

*1 The laser classification for FDA (CDRH) is implemented based on IEC60825-1 in accordance with the requirements of Laser Notice.

* Download CAD file or product manual for larger image/text and more detail.

sr-700_710_700ha_dimension_01.gif

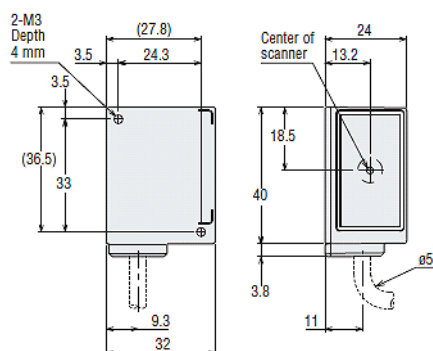

sr-700_710_700ha_dimension_02.gif

sr-700_710_700ha_dimension_03.gif

HEAD CABLE

